

arneg

www.arneg.it

Serve-over counters

Belgrado 2



YOUR NATURALLY INNOVATIVE PARTNER FOR RETAIL SOLUTIONS

into the World

Belgrado 2		Lunghezza senza spalle Length without ends Länge ohne Seiten Longeur sans joues Longitud sin laterales Длина без боковин	Temperatura di esercizio Working temperature Betriebstemperatur Temp. de fonctionnement Temperatura de trabajo Рабочая температура	Superficie di esposizione orizzontale Horizontal display surface Gesamte Ausstellfläche Surface d'exposition horizontale Superficie de exposición de apoyo Горизонтальная площадь экспозиции	Capacità utile Net volume Nutzleistung Capacité utile Capacidad útil Полезный объем
			°C	m ²	dm ³
VDL-VDA-SELF	70	937	0°C/+2°C +2°C/+4°C	0,66	131
		1250		0,88	175
		1875		1,31	263
		2500		1,75	350
		3125		2,19	438
		3750		2,63	525
	80	937		0,75	150
		1250		1,00	200
		1875		1,50	300
		2500		2,00	400
		3125		2,50	500
		3750		3,00	600
	83	937		0,78	156
		1250		1,04	208
		1875		1,56	311
2500		2,08	415		
3125		2,59	519		
3750		3,11	623		
90	937	0,84	169		
	1250	1,13	225		
	1875	1,68	338		
	2500	2,25	450		
	3125	2,81	563		
	3750	3,38	675		
CK VDL-VDA	70	1250	+2°C/+4°C	1,13	175
		1875		1,69	263
		2500		2,25	350
	80	1250		1,25	200
		1875		1,88	300
		2500		2,50	400
	90	1250		1,38	225
		1875		2,06	338
		2500		2,75	450
FH VDL-VDA-SELF	90	937	0°C/+2°C	0,76	83
		1250		1,02	111
		1875		1,53	166
		2500		2,04	222
		3750		3,05	333
BD VDL-VDA	70	1250	Ambiente Ambient	0,76	88
		2500		1,53	176
		1250		0,98	113
	90	1875		1,48	170
		2500		1,97	226
		3750		2,96	340
BT VDL-VDA	90	1250	-18°C/-25°C	1,03	319
		1875		1,58	479
		2500		2,10	638
		3750		3,09	957
		TCPW VDL-VDA		80	937
1250	0,56				
90	937		0,54		
	1250		0,76		
TCBM VDL-VDA	90	937	0,54		
		1250	0,76		
ATB		1250	+2°C/+4°C	1,04	665

* Il dato varia in funzione della quantità e del tipo di contenitori Gastronorm utilizzati, This data may vary depending on the number and type of Gastronorm trays, Die Zahl variiert je nach Menge und Art von Gastronorm Behältern, Le chiffre varie selon la quantité et le type de bacs GN utilisés, La cifra varía dependiendo de la cantidad y tipo de recipientes Gastronorm utilizados, Показатель варьируется в зависимости от количества и типа используемых гастроёмкостей



VDL



VDA

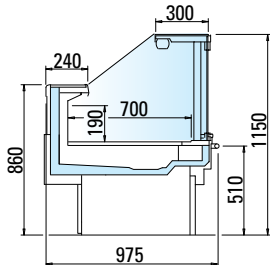

VDL-VDA 70

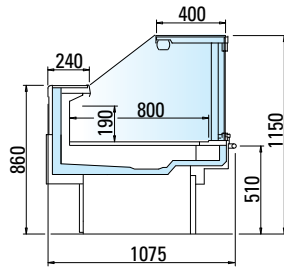

VDL-VDA 80

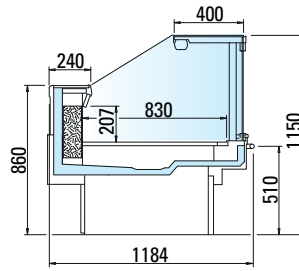

VDA-VDL 83

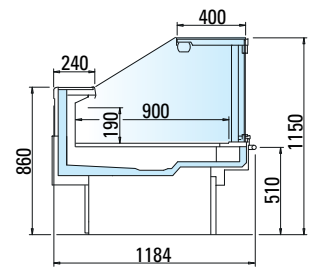

VDL-VDA 90

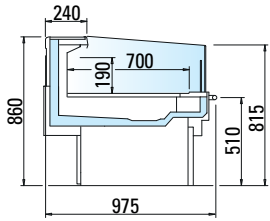

SELF 70

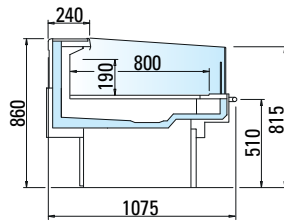

SELF 80

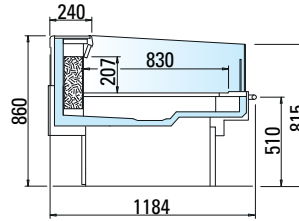

SELF 83

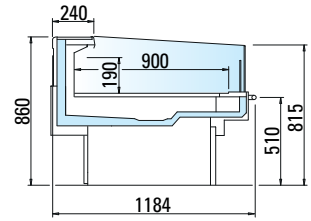

SELF 90

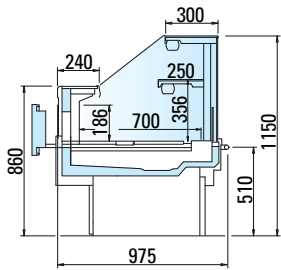

CK VDL-VDA 70

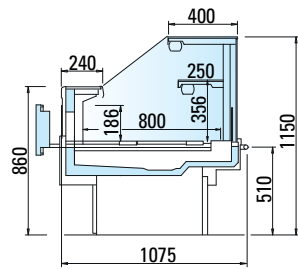

CK VDL-VDA 80

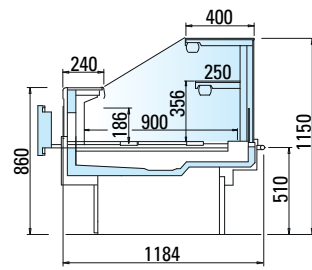

CK VDL-VDA 90

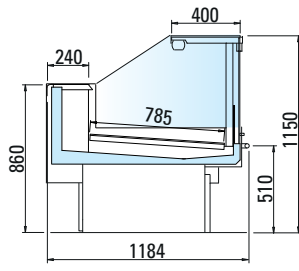

FH VDL-VDA 90

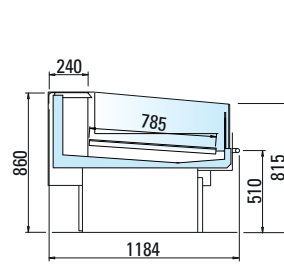

FH SELF 90

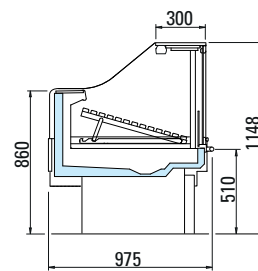

BD VDL-VDA 70

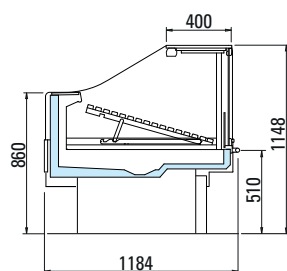

BD VDL-VDA 90

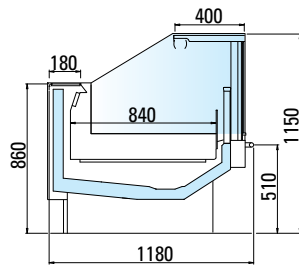

BT VDL-VDA

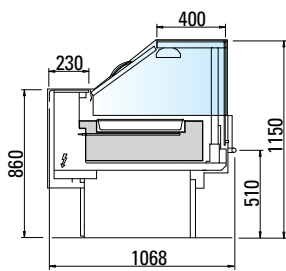

TCPW VDL-VDA 80

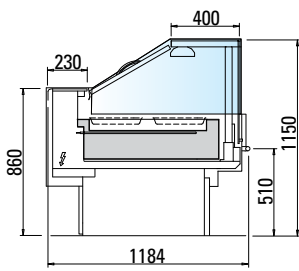

TCPW VDL-VDA 90

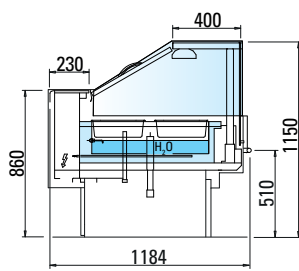

TCBM VDL-VDA 90

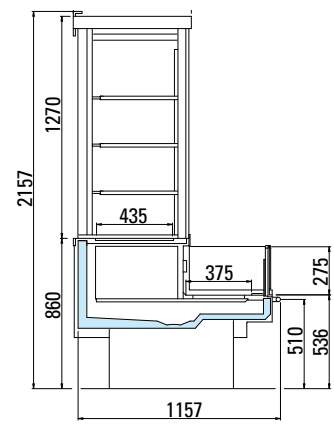

ATB



Trade Technology Copmany +7(495)768-33-52
Russia Moscow Central'naya street 24a
e-mail: sale@ttechnology.ru